

## ELITE 2030 LED NEON

## OUTDOOR / EXTERIOR



ELITE is a silicone co-extrusion IP67 neon that offers UV resistance, chemical stability, and protection against abrasion. It is freely configurable in length by cutting and capping with compatible endcaps.

*Vertical Bending.*

*Up to 52ft run length from the single power feed. Dust-Free matte finish.*

- Made of DOW Chemical SILASTIC™ ET-7021 silicone rubber, which provides high transparency and high strength.
- Environmental protection grade silicone material with integrated extrusion molding process.
- Unique optical light distribution structure design, uniform lighting surface and no shadow.
- IP67 protection level, resistant to salts, acids, alkalis and UV.
- Excellent toughness, simple and stylish appearance, delicate and unique.
- 5 years warranty, working life > 50000 hours.



## Technical Data

<b>Dimension</b>	1.18in x 0.79in
<b>Voltage</b>	DC24V
<b>RA</b>	>90
<b>Dimming</b>	Dimmable
<b>Efficacy</b>	69.7LM/W @4000K
<b>Storage Temp</b>	-40°C ~ 60°C
<b>Standard Length</b>	20ft / 21ft
<b>Max Prod. Length</b>	100ft
<b>Warranty</b>	5 Years

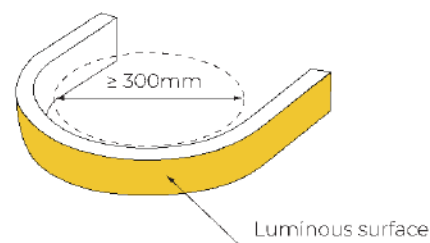

Min Bending diameter

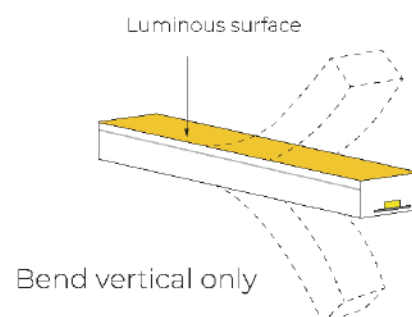

## Dimensions / Structure

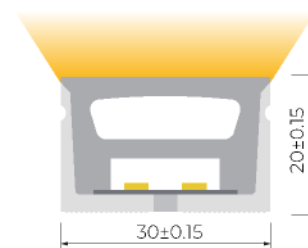
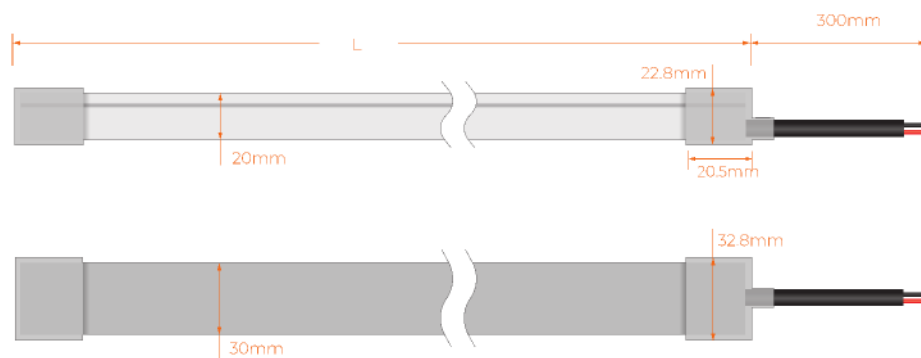

Unit: mm  
Cross section



IK10



Protection



Dirt Resistant



One Bin

3

SDCM



1ft-100ft

## Light Distribution Curve

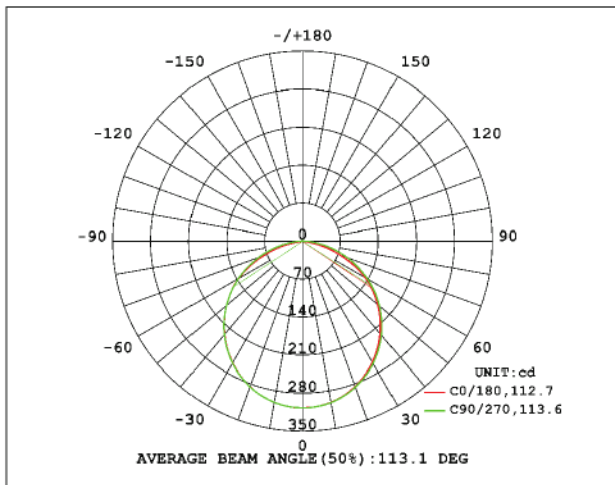

## Illuminance Curve

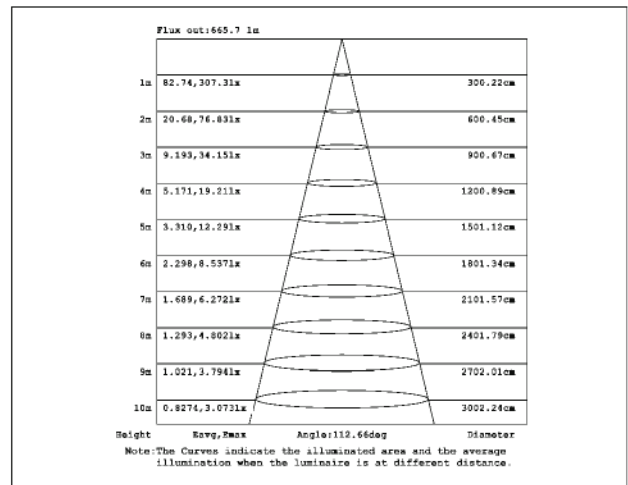

## Static Colour

Color Temperature	3.4W/ft LM/ft	4.3W/ft LM/ft	5.1W/ft LM/ft	Cutting Interval (in)	CV/CC
2700K	221	269	310	3	CC
3000K	231	282	325	3	CC
3500K	241	293	338	3	CC
4000K	244	298	345	3	CC
5000K	232	281	324	3	CC
6500K	233	282	326	3	CC
Red	84	102	115	3	CC
Green	210	256	293	3	CC
Blue	44	53	61	3	CC
Yellow	70	82	95	3	CC
Orange	86	101	113	3	CC
Pink	180	218	252	3	CC
Max. Run Length	52ft	42ft	35ft		

## Tunable White

Color Temperature	3.4W/ft LM/ft	4.3W/ft LM/ft	5.1W/ft LM/ft	Cutting Interval (in)	CV/CC
2700K	111 1.7W/ft channel	137 2.1W/ft channel	162 2.6W/ft channel	3	CV
6000K	113 1.7W/ft channel	141 2.1W/ft channel	167 2.6W/ft channel	3	CV
2700K+6000K	224 Full light	277 Full light	327 Full light	3	CV
Max. Run Length	21ft	21ft	21ft		

## RGB & RGBW

Color Temperature	3.4W/ft LM/ft	4.3W/ft LM/ft	5.1W/ft LM/ft	Cutting Interval (in)	CV/CC
RGB	96	118	136	3	CV
RGBW	103	126	146	3	CV
Max. Run Length	21ft	21ft	21ft		

\*CV: Constant Voltage CC: Constant Current.

\*The given color temperature is the final neon strip color temperature. All given data are for reference only, it can vary up to 10% because of tolerances.

\*Maximum Run Length refers to single side power feed in serial connection to drive the length.

### Integral End Cap

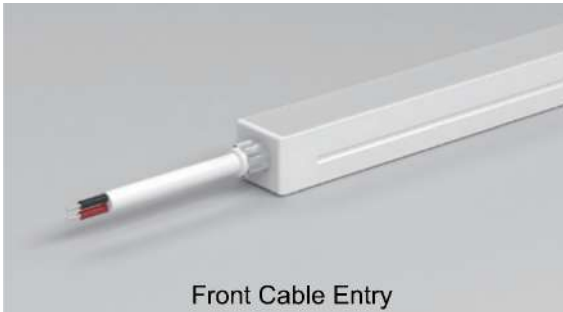

Front Cable Entry

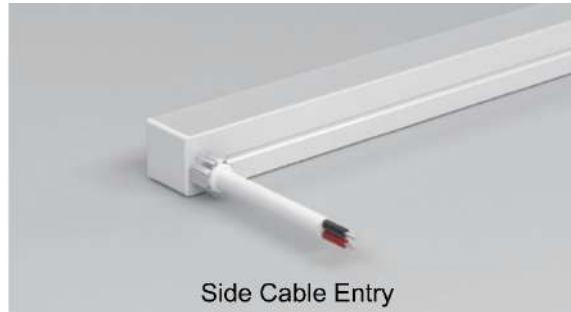

Side Cable Entry



Bottom Cable Entry



Closed End Cap

### Solderless End Cap

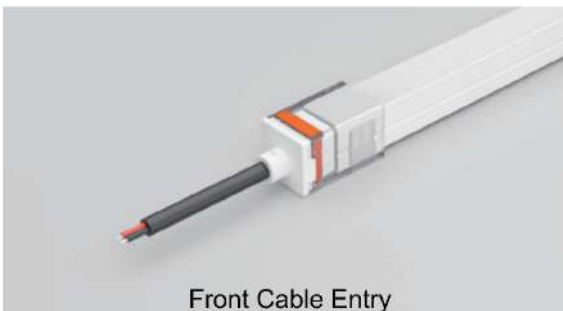

Front Cable Entry



Side Cable Entry



Bottom Cable Entry



Closed End Cap

## Track-to-Track Solderless Connections

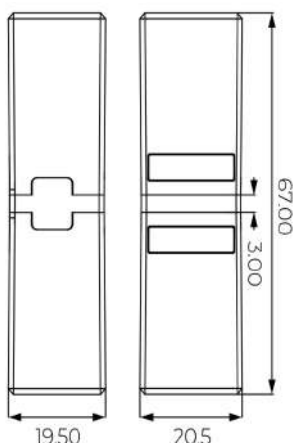

Track-to-Track (No Cable Entry)

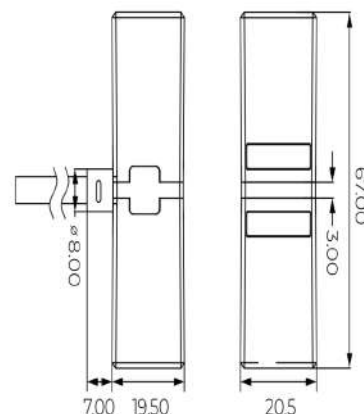

Track-to-Track (With Cable Entry)

## Mounting Equipment

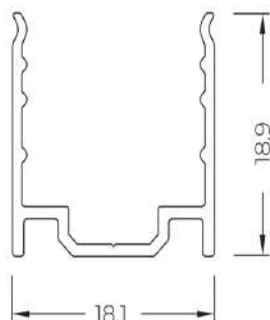

Aluminium Track

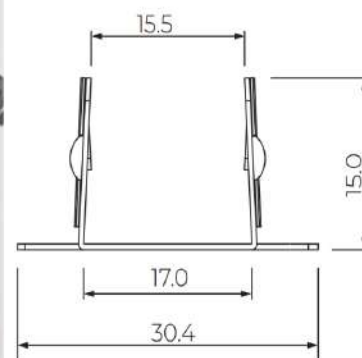

Flexible Track

## Cutting

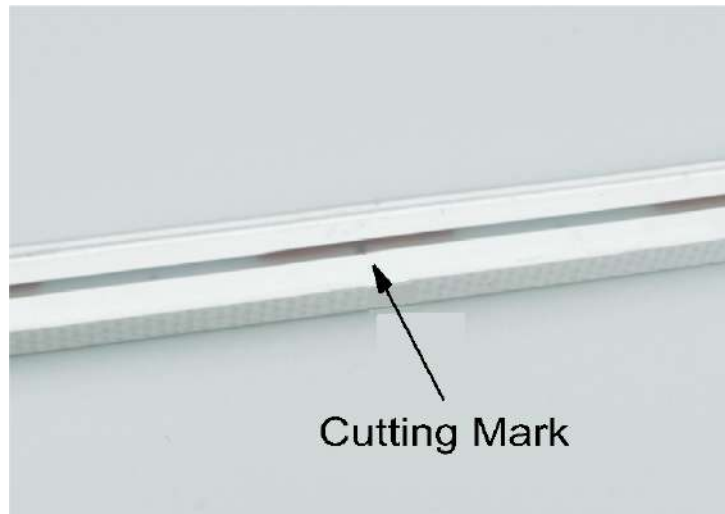

## Single Colour Connection

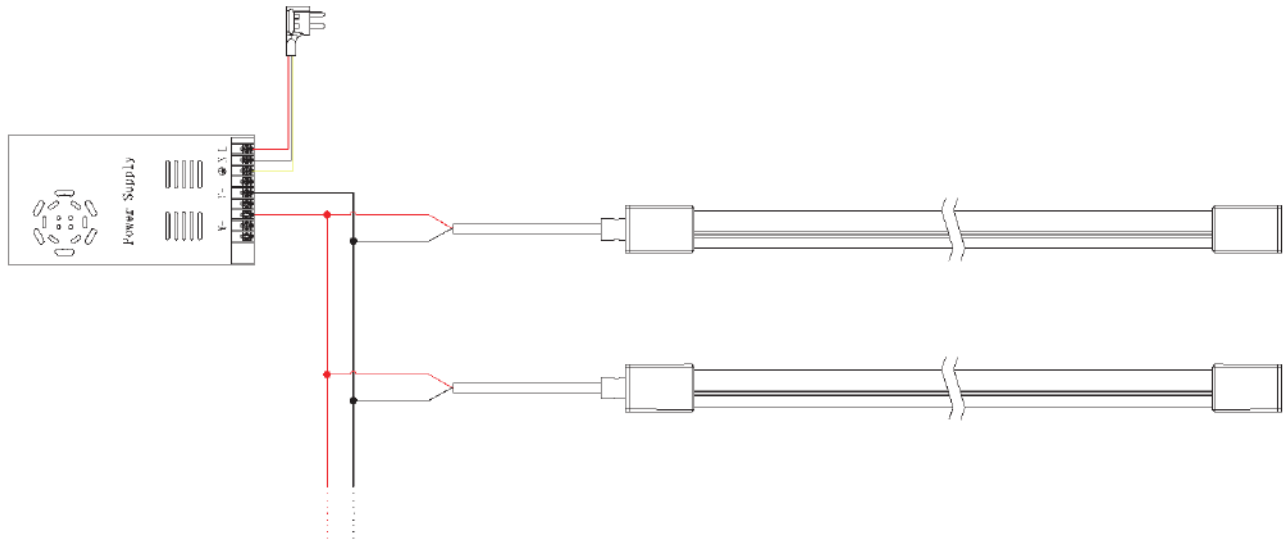

## Tunable White Connection

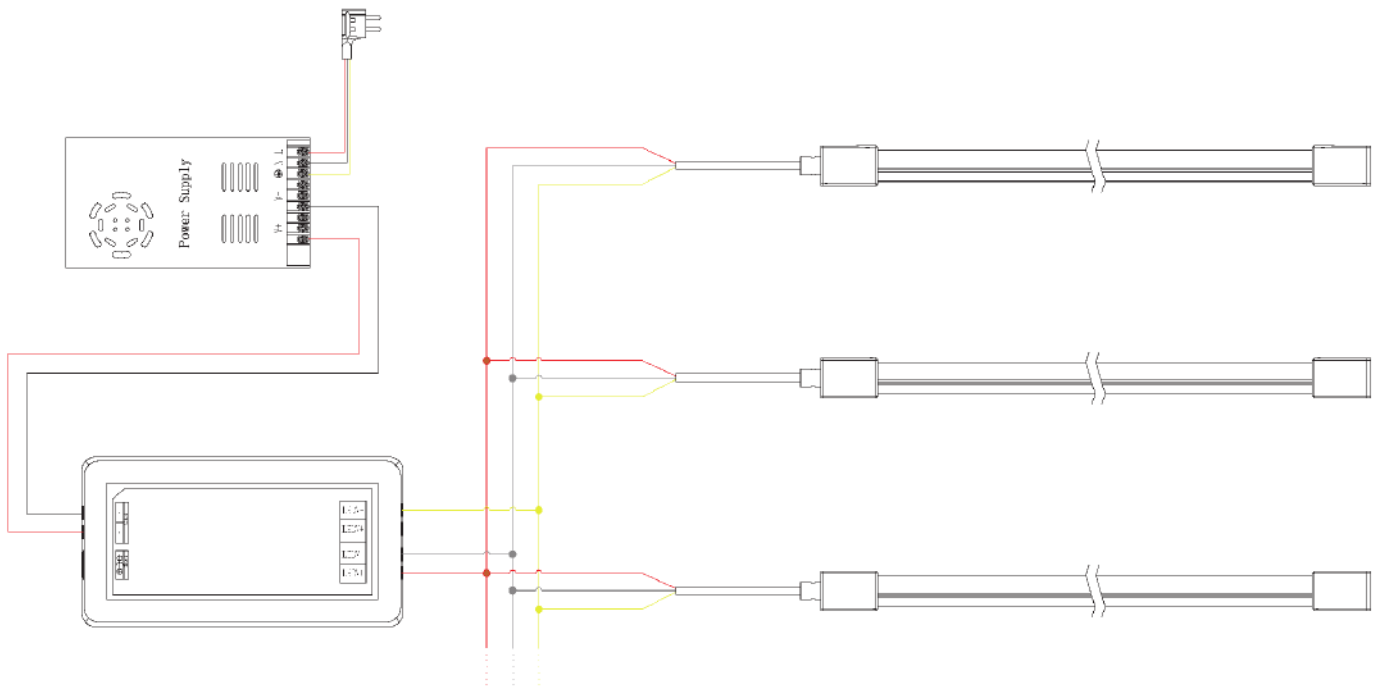

## RGB Connection

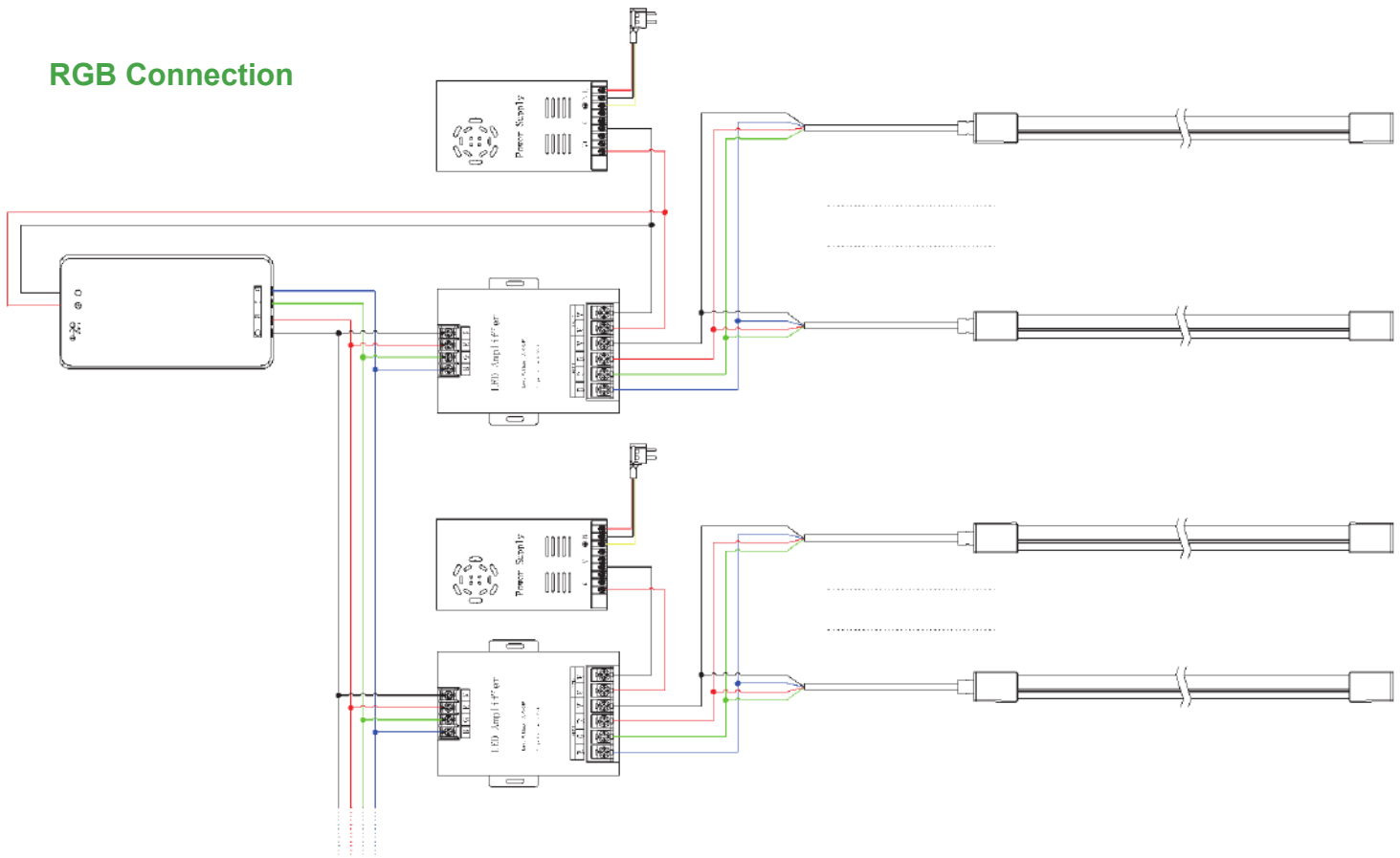

## RGBW Connection

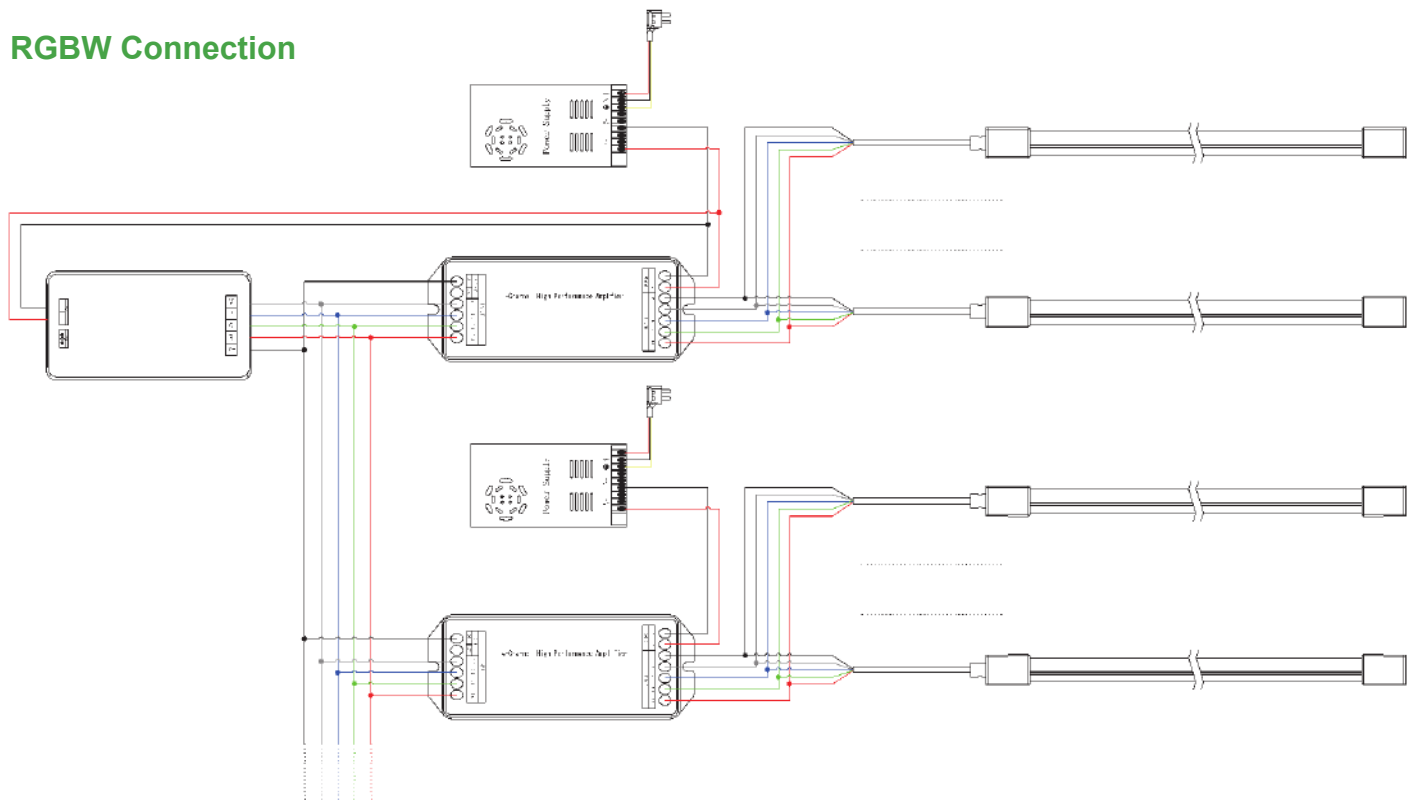

## Installation Precautions

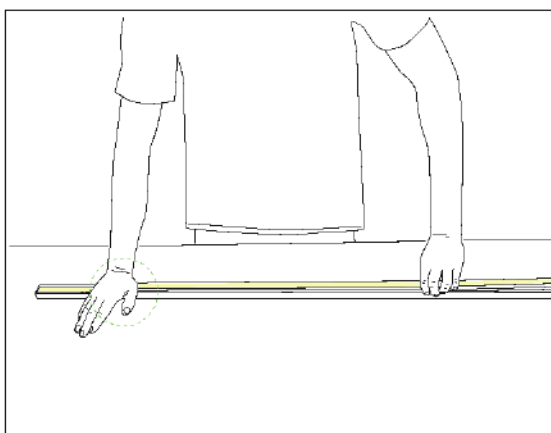
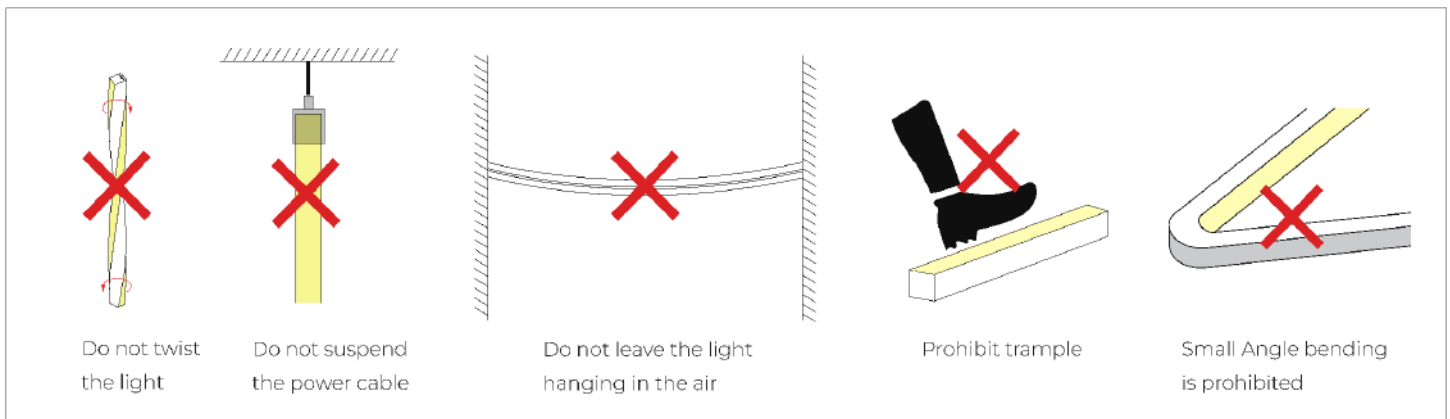
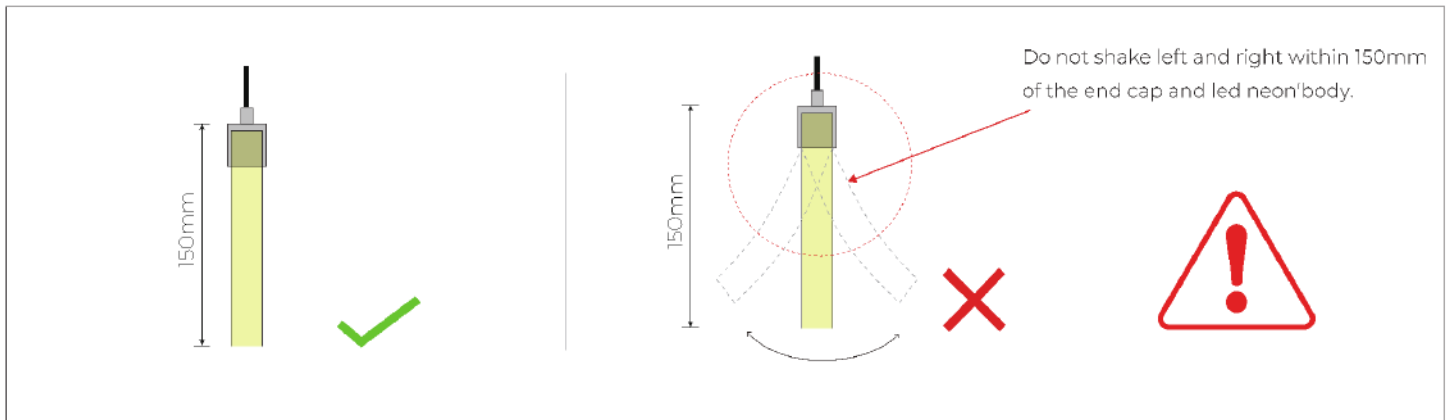

- Please press the led strip with your palm to slowly insert the led strip into the groove, and gently straighten the led strip above the groove with your right hand.
- Try to keep the led strip in a flat state during the installation process.

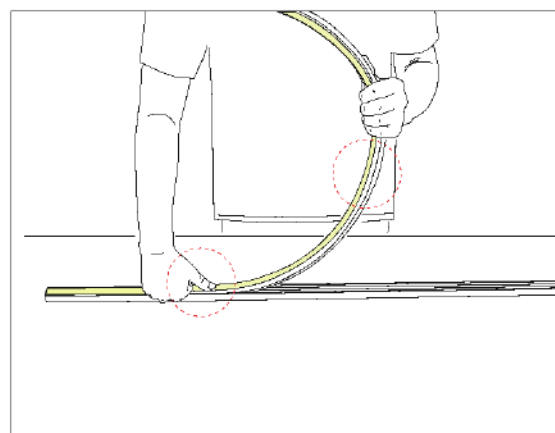

- Do not press the led strip with a single finger, it is easy to damage the internal parts of the led strip.
- The bent arc of the led strip should not be too large during installation.



## Installation Precautions

Figure 1

Hold the light and rotate it 90°, make ensure the light is bent in the correct direction.

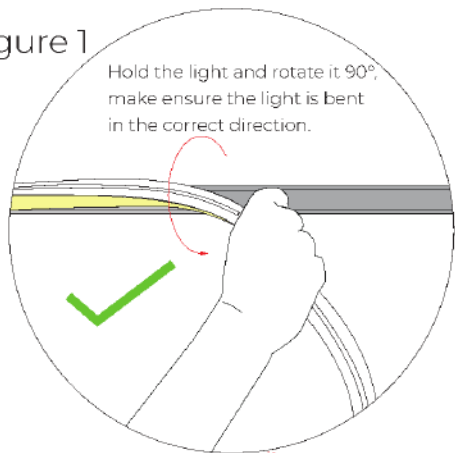

Figure 2

Luminous Surface



### 1.Installer:

-Press the light with the palm of the left hand to slowly load it into the slot. Straighten the light with right hand, hold it and rotate it 90 ° to droop it in the direction of your hand. See Figure 1.

-Do not bend the luminous surface to the side. See Figure 2.

### 2.Assistant:

-Cooperate with the installer to lift the reel of the light, and then slowly deliver the light to installer. Do not pull or twist the light during the installation.

## Installation Precautions

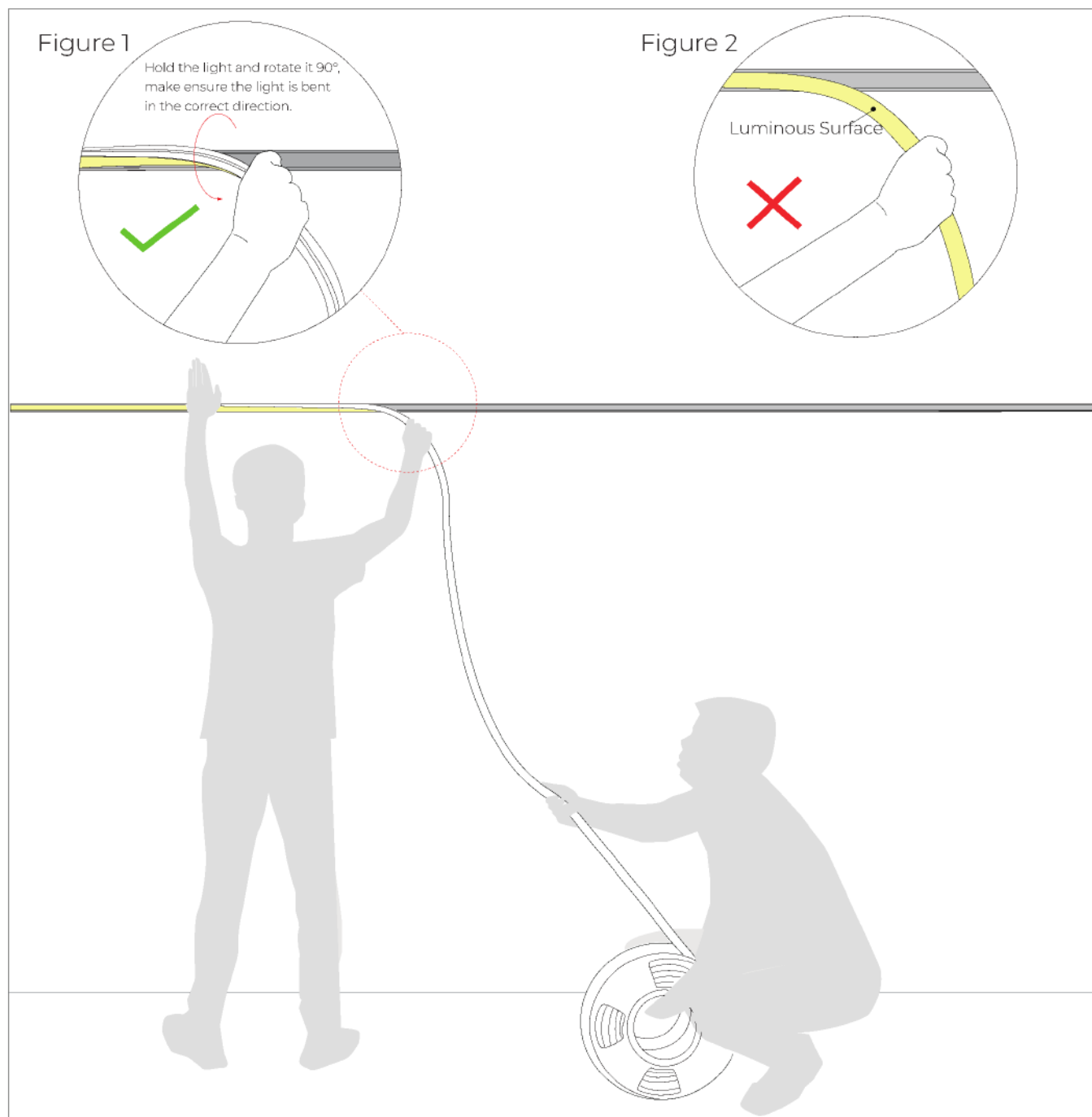

### 1.Installer:

- Press the light with the palm of the left hand to slowly load it into the slot. Straighten the light with right hand, hold it and rotate it 90 ° to droop it in the direction of your hand. See Figure 1.
- Do not bend the luminous surface to the side. See Figure 2.

### 2.Assistant:

- Cooperate with the installer to slowly deliver the light to installer. Do not pull or twist the light during the installation.

## Installation Precautions

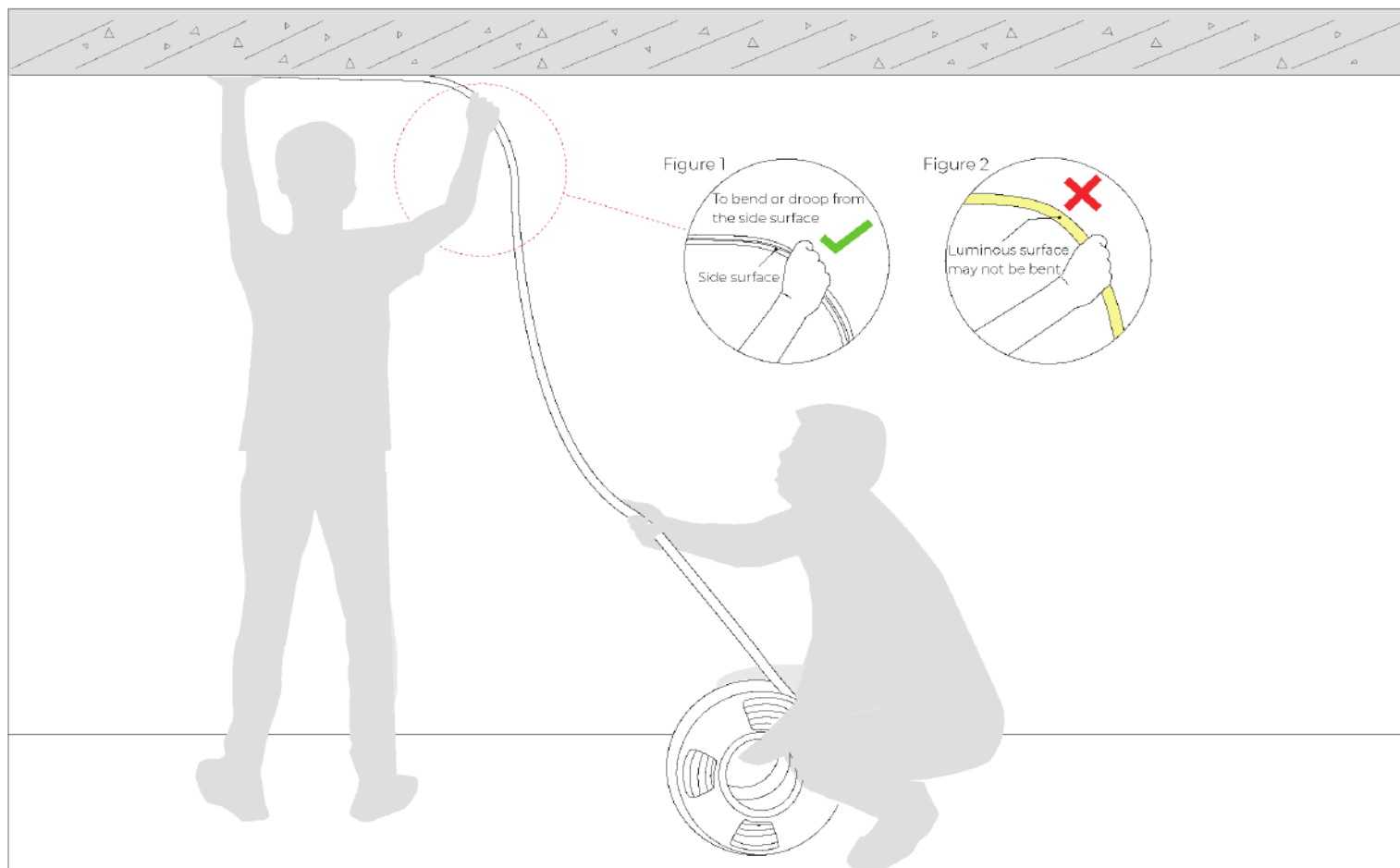

### 1.Installer:

- Press the light with the palm of the left hand to slowly load it into the slot. Straighten the light with your right hand so that it droop naturally. See Figure 1.
- Luminous surface may not be bent. See Figure 2.

### 2.Assistant:

- Cooperate with the installer to slowly deliver the light to installer. Do not pull or twist the light during the installation.