

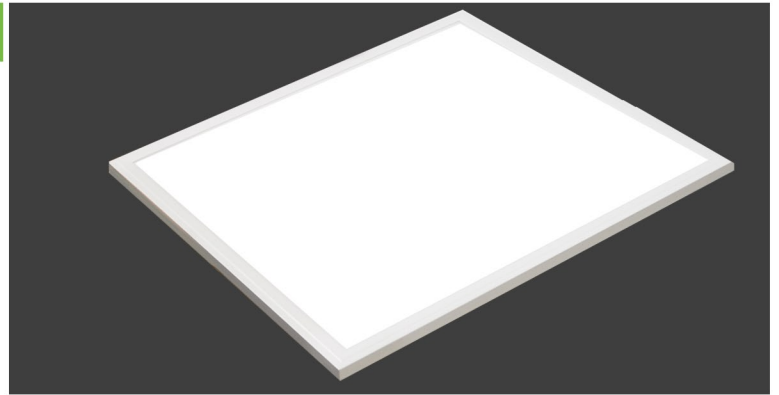

Model: **FP2x2-120V-40W-4000K**

Features:

- Slim Profile**
- Easy Installation**
- No Shadows or Hotspots**
- IC Rated**
- Energy Efficient & Low Maintenance**
- Long Life Span > 50,000 hrs**
- Driver Included (Meanwell)**



Technical Specifications

Power Consumption: **40W**
 Input Voltage: **AC 120V**
 Luminous Flux: **> 3400 lm**

Material: PMMA+AL
 Dimensions: 603 x 603 x 10.5 mm

IC Rated
 IP Rating: IP 54
 Power Factor(PF): > 0.92
 CRI: RA>85

Installations: T-Grid Drop Ceiling
 Suspended
 Recessed Drywall

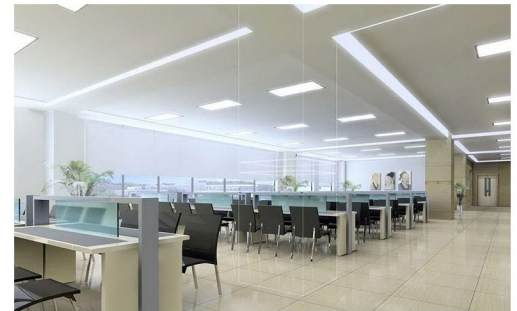

CCT: Natural White (4000K)
 Dimming: 0-10V

Non T-Bar Installation - Recessed Installation

Cut Hole in Drywall Ceiling



Install Spring Clips onto Panel
 Flip Spring Clips Upright

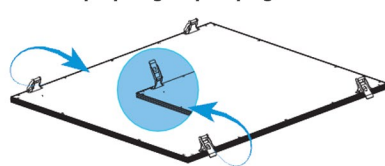

Insert Panel into Hole

